

TECHNICAL DATA

REGUPOL SONUSCLIP SC100

The **REGUPOL sonusclip SC100** is designed to reduce noise transmission through walls and ceilings. The **sonusclip SC100** is used to resiliently mount gypsum board. The rubber isolators absorb vibration and effectively decouple the gypsum board from the framing. The **sonusclip SC100** significantly improves the acoustic performance for both STC (airborne) and IIC (structure-borne) ratings. Each **sonusclip SC100** has a design load rating of 36 lb and can support two layers of 5/8" gypsum board when spaced at 24" x 48" on center. For detailed layouts and spacing recommendations, please see the installation guide or contact us.



Applications

- › Walls
- › Ceilings
- › Resilient Mounting

Property	Result	Standard	Note
Deflection	3 mm		
Design Load	36 lb / clip		
Fire Resistance Testing	Pass	ASTM E119	Visit UL Product iQ for details
VOC Treated	Yes		

Dimensions

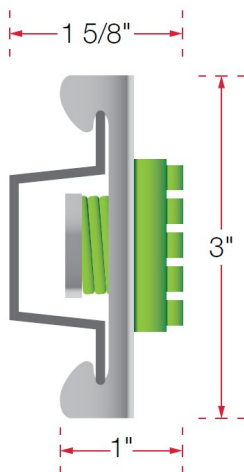

REGUPOL sonusclip SC100

- › Length: 3"
- › Width: 1-1/4"
- › Depth: 1"
- › Depth with Hat-Channel: 1-5/8"

Hat-Channel

- › 25 ga, hemmed-edge
- › Width Top: 1-1/4"
- › Width Bottom: 2-9/16" to 2-11/16"
- › Depth: 7/8"

TECHNICAL DATA

REGUPOL SONUSCLIP SC100



Wood Stud Wall Assemblies



Framing: 2 x 4 Wood Stud, 16" o.c.
Insulation: 3-1/2" Fiberglass
Isolators: None
Mounting: None
Side 1: 5/8" Gypsum Board
Side 2: 5/8" Gypsum Board



Framing: 2 x 4 Wood Stud, 16" o.c.
Insulation: 3-1/2" Fiberglass
Isolators: REGUPOL sonusclip SC100
Mounting: Hat-Channel, 25 ga
Side 1: 5/8" Gypsum Board
Side 2: 5/8" Gypsum Board



Framing: 2 x 4 Wood Stud, 16" o.c.
Insulation: 3-1/2" Fiberglass
Isolators: REGUPOL sonusclip SC100
Mounting: Hat-Channel, 25 ga
Side 1: 5/8" Gypsum Board
Side 2: 2 Layers 5/8" Gypsum Board

Steel Stud Wall Assemblies



Framing: 3-5/8" Steel Stud, 16" o.c.
Insulation: 3-1/2" Fiberglass
Isolators: None
Mounting: None
Side 1: 5/8" Gypsum Board
Side 2: 5/8" Gypsum Board

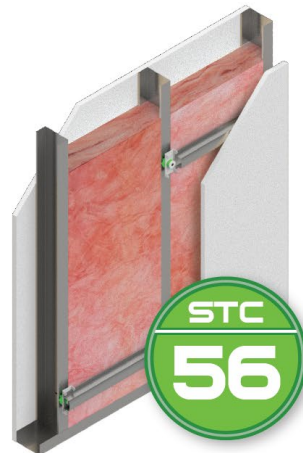

Framing: 3-5/8" Steel Stud, 16" o.c.
Insulation: 3-1/2" Fiberglass
Isolators: REGUPOL sonusclip SC100
Mounting: Hat-Channel, 25 ga
Side 1: 5/8" Gypsum Board
Side 2: 5/8" Gypsum Board



Framing: 3-5/8" Steel Stud, 16" o.c.
Insulation: 3-1/2" Fiberglass
Isolators: REGUPOL sonusclip SC100
Mounting: Hat-Channel, 25 ga
Side 1: 5/8" Gypsum Board
Side 2: 2 Layers 5/8" Gypsum Board

TECHNICAL DATA

REGUPOL SONUSCLIP SC100



2 x 10 Wood Floor-Ceiling Assemblies

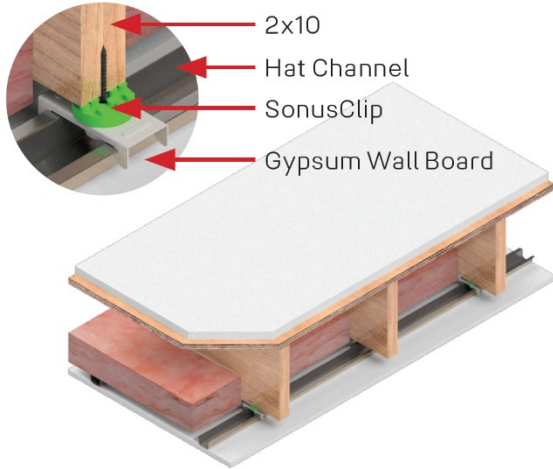

Floor Covering	Underlayment	STC	IIC
None	None	60	51
Hardwood	None	60	58
Hardwood	sonus core 3	59	58
Hardwood	sonus core 10	60	60
Tile	sonus core 5	61	55
Vinyl	None	61	55

- Floor:** 1" Gypsum Topping over 3/4" Plywood
- Framing:** 2 x 10, 16" o.c.
- Insulation:** 3-1/2" Fiberglass
- Isolation:** REGUPOL sonusclip SC100
- Mounting:** Hat-Chanel, 25 ga
- Ceiling:** 5/8" Gypsum Board

18" Open Web Floor-Ceiling Assemblies

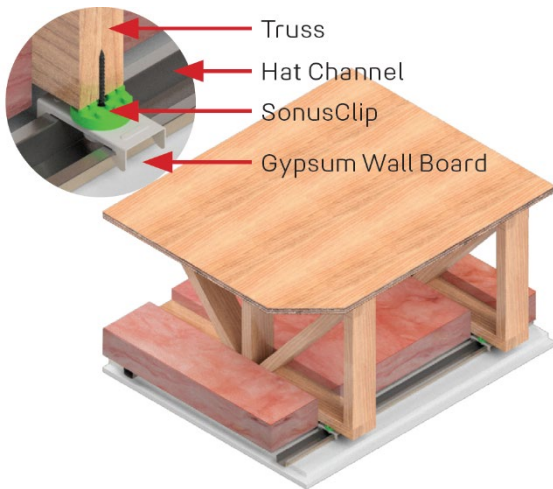

Floor Covering	Underlayment	STC	IIC
Hardwood	None	60	53
Hardwood	sonus core 3	60	55
Hardwood	sonus core 5	60	55
Hardwood	sonus core 10	60	55
Tile	sonus core 5	60	58
Vinyl	None	60	53

- Floor:** 3/4" Plywood
- Framing:** 18" Open Web Truss, 24" o.c.
- Insulation:** 3-1/2" Fiberglass
- Isolation:** REGUPOL sonusclip SC100
- Mounting:** Hat-Chanel, 25 ga
- Ceiling:** 2 Layers 5/8" Gypsum Board

For additional test results, please contact us or visit our website and review the Test Reports section.

TECHNICAL DATA

REGUPOL SONUSCLIP SC100



Example Assembly

Wood Stud Decoupling

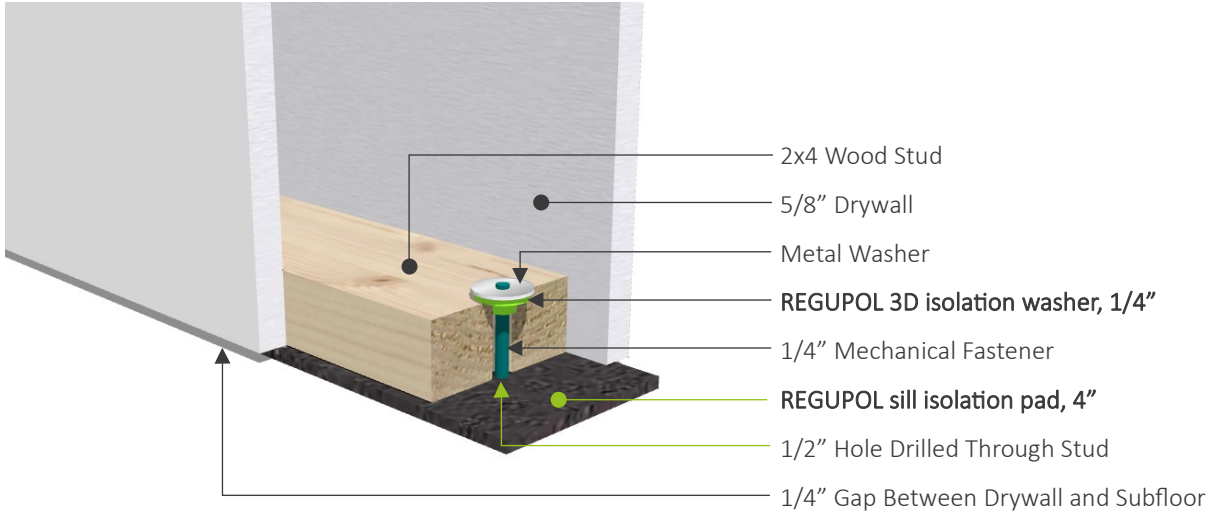

Accessories

REGUPOL
sonusclip DE90



REGUPOL
sill isolation pad



REGUPOL
3D isolation washer



REGUPOL
sonus core

